

Fusible HDPE IPS Service Saddle 3/4" FPT

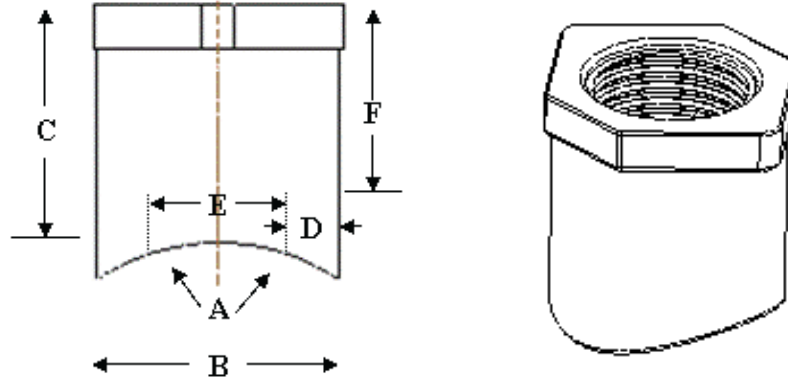

Lateral IPS	Part Number	A	B	C	D	E	F Length of Threads	Thread Diameter
1"	AFLS07-010	1.315	1.315	1.25	.25	.815	1.0	.75 FPT
1 1/4"	AFLS07-012	1.660	1.315	1.25	.25	.815	1.0	.75 FPT
1 1/2"	AFLS07-015	1.900	1.315	1.25	.25	.815	1.0	.75 FPT
2"	AFLS07-020	2.375	1.315	1.25	.25	.815	1.0	.75 FPT
3"	AFLS07-030	3.500	1.315	1.25	.25	.815	1.0	.75 FPT
Flat	AFEL07-010	0.00	1.315	1.5	.25	.815	1.0	.75 FPT

1. For Landscape Irrigation Systems Only
2. Metric sizes also available
3. "Flat" for Butt fusing or Socket fusing at lateral ends
4. HDPE 4710 DR11
5. Patent Pending

AquaFuse™ by CMF GLOBAL

Telephone: 619-869-8919
Fax: 619-330-4532

PATENTED

2445 Fenton Street
Chula Vista, CA 91914-3517

1-877-586-6060 24 Hour Technical Hotline ■ 25 YEAR LIMITED SYSTEM WARRANTY

PRODUCT INSTALLATION TRAINING AVAILABLE

In Fusion We Trust™